

Reinforced Concrete (RC Square Pile)

DESIGN & MANUFACTURING REFERENCE

Design	ACI 5434-15	Design, Manufacture and Instalation
	SNI 03-2847-2013	Structural Concrete Requirment

SPECIFICATION OF SQUARE MATERIAL

Item	Specification	Reference	
Aggregate		ASTM C33 - 2016	(Standard Specification Concrete Aggregates)
		SNI 8321 - 2016	(Concrete Aggregates Specification)
Cement		SNI 15-2049-2004	(Portland's Cement)
Admixture		ASTM C494-2016	(Standard Specification for Chemical Admixture for Concrete)
Concrete	Compressive Strenght at 28Days : 500kg/cm ² (Cube) 41,5Mpa (Cylinder)	ASTM C494-2016	(Structural Concrete Requirment)
Spiral Wire	SWM-A / SWM-P	JIS G 3532 : 2011	(Low Carbon Steel Wires)
Reinforcement Bar	BjTS 420 for D ≥ 13mm	SNI 2052-2017	(Concrete Reinfoecement Steel Bar)
	BjTS 280 for D < 13mm	SNI 2052-2017	(Concrete Reinfoecement Steel Bar)
Joint Plate	SS400	JIS G 3101 : 2011	(Roled Steel for General Structure)
Welding	AWS E6013	AWS D1.1 : 2000	(Structural Welding Code - Steel)

Reinforced Concrete (RC Square Pile)

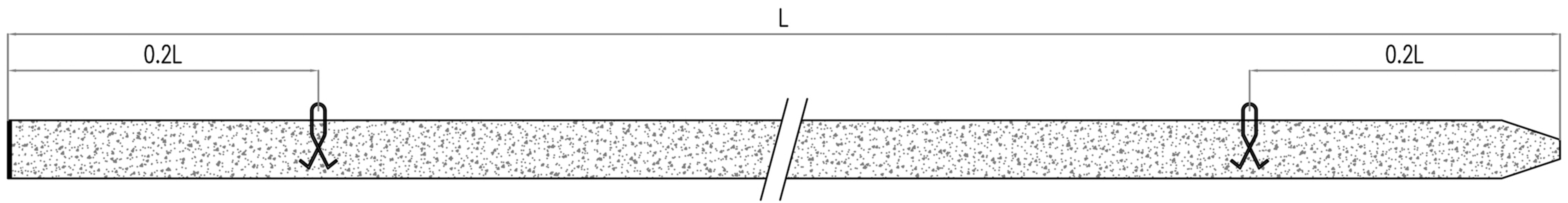

Single Plate Moncong

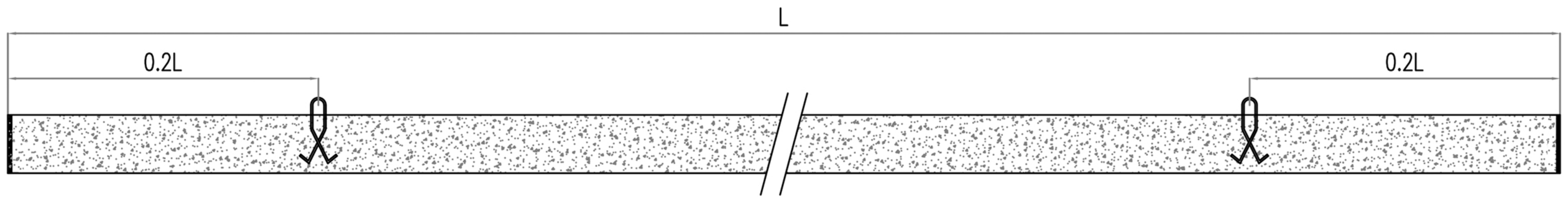

Double Plate (DP)

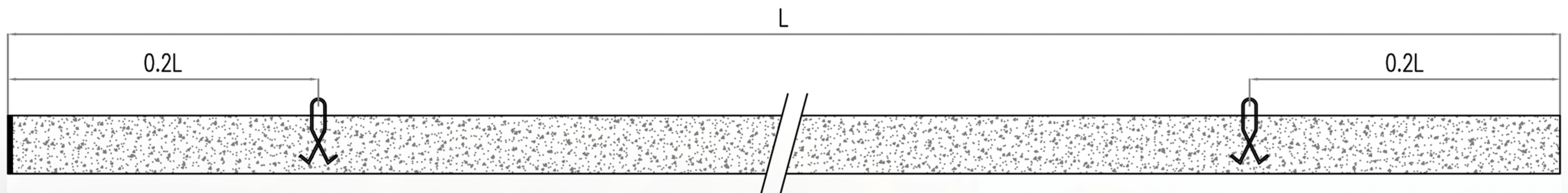

Single Plate Papak

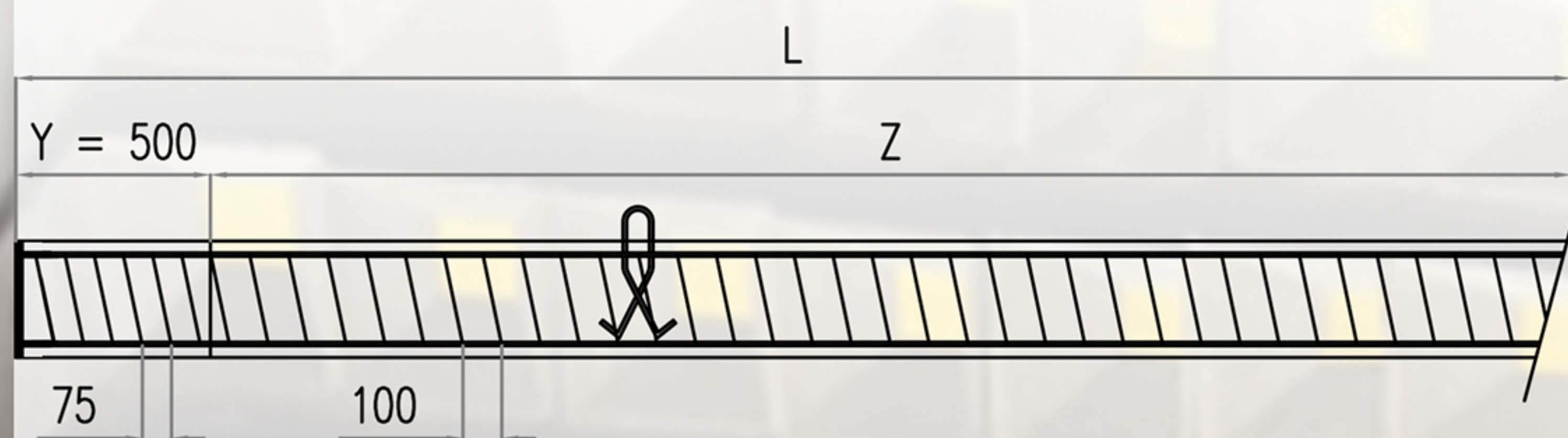

Stirrups Pitch Instalation

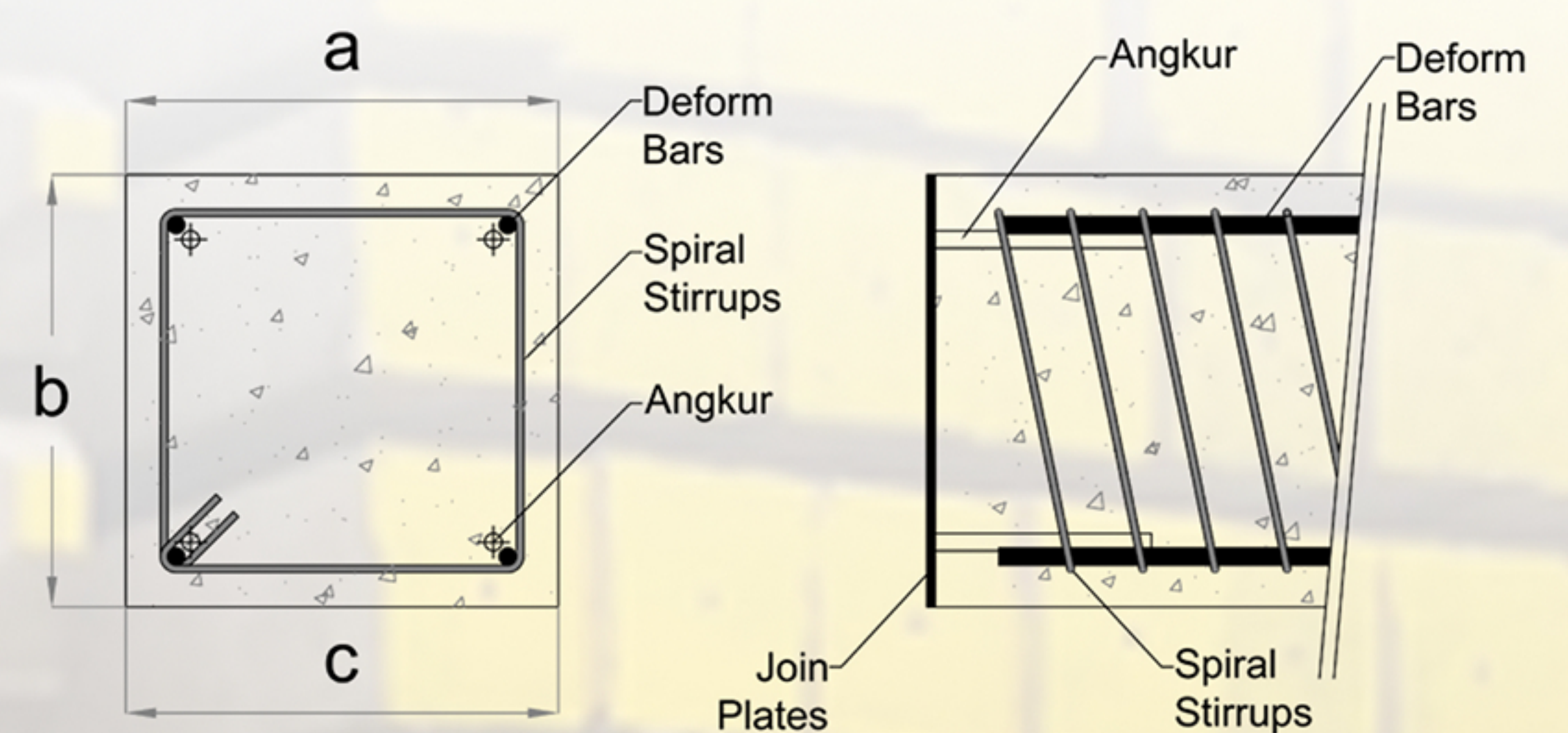

Front View

Side View

UNITY STANDARD RC PILES DETAILS

Normal Size (w)	Pile Class	Available Length (L)	Dimension			Nominal Weight	Main Reinforcement		Link Size	Stirrups Pitch at		Joint Plates	Axial Comp. Load	
			a	b	c		Deform Bars	Link Size		Y	Z		Maximum Axial Working Load (ton)	Recomended Working Load (ton)
(cm)		(mm)	(mm)	(mm)	(mm)	(kg)	(nos)	(Ø mm)	(Ø mm)	(mm)	(mm)	(mm)		
20 x 20	Class A	3000	205	195	200	288	4	10,00	4,0	50 - 500	100	5	52,8	48,0
		6000	205	195	200	576	4	10,00	4,0	50 - 500	100	5	52,8	48,0
	Class B	3000	205	195	200	288	4	13,00	4,0	50 - 500	100	5	55,6	50,0
		6000	205	195	200	576	4	13,00	4,0	50 - 500	100	5	55,6	50,0
25 x 25	Class A	3000	255	245	250	450	4	13,00	4,0	50 - 500	100	5.5	89,8	80,0
		6000	255	245	250	900	4	13,00	4,0	50 - 500	100	5.5	89,8	80,0
	Class B	3000	255	245	250	450	4	16,00	4,0	50 - 500	100	5.5	92,1	86,0
		6000	255	245	250	900	4	16,00	4,0	50 - 500	100	5.5	92,1	86,0
30 x 30	Class A	3000	305	295	300	648	4	13,00	4,0	50 - 500	100	6	126,2	110,0
		6000	305	295	300	1296	4	13,00	4,0	50 - 500	100	6	126,2	110,0
	Class B	3000	305	295	300	648	4	16,00	4,0	50 - 500	100	6	131,7	120,0
		6000	305	295	300	1296	4	16,00	4,0	50 - 500	100	6	131,7	120,0

Note : Concrete Grade K-450 (equal f_c' 37,65 Mpa) at 28 days